

# BUMPER CATALOG



**ROAD CHOICE<sup>®</sup>**





We are committed to  
keeping trucks on the road  
and moving forward, by  
providing quality parts to  
all who repair heavy-duty

**CONFIDENCE.**  
**COVERAGE.**  
**COMMITMENT.**



---

# TABLE OF CONTENTS

## INTRO

Introduction .....	4
Part Numbers .....	5

## TOP MOVERS

Mack.....	7
Volvo.....	9
Ford .....	9
Freightliner.....	10
International .....	12
Kenworth .....	12
Peterbilt .....	14
Western Star.....	17

## MACK

R600, R700 .....	19
Western Con., RD688, RD390, 1989-2001.....	20
CH Series SFA, 1994-2004 .....	21
CH Series SBA, 1994-2004 .....	22
CH Series SBA, Pre 1994 .....	23
CL Series 10.5" Break-Back, 1994-2003	
MR, MD Series 7" Break-Back, 2018 & Older.....	24

RD688, RD690 6" Break-Back, 1994-2003	
RD Series SBA 6" Break-Back, 1979-1988.....	25
Granite, CV513, CV533 SFA, 2003 & Newer.....	26
CX Series, Vision SBA, 2001-2004.....	27
CV Series RD688DM, 2003-2007	
CXN Series, 2005 & Newer   CXP, 2007& Newer .	28
CHN613, 2005 & Newer .....	29
CXU613, 2008-2010 .....	30

## VOLVO

WX, Xpeditor, 2003-2010	
WA, WIA SBA, 1988-1997.....	32
VNL Series, 2003 & Older	
WG SBA, 1995 .....	33
VNM42T, VNM64T, 1998-2003	
VNL42T, VNL64T, 1996-2003 .....	34
White SBA, 1987-2001	
VNM Series, 2004 & Newer .....	35
VNL Series, 2004 & Newer .....	36
VT Series, 2006-2008	
VNR Series, 2018 & Newer .....	37
VNL Series, 2018 & Newer.....	38

## IMAGES IN THIS CATALOG

The images shown in this catalog are best representations of our products, however, they are representative only and may sometimes not match actual product. Add-on items shown in images, such as external tow apparatus, fog lamps and other non-Road Choice items attached to bumpers and accessories are not included in the product offered.



# WITH ROAD CHOICE®, CONFIDENCE COMES WITH EVERY BUMPER PURCHASE.

Road Choice is your best source of top-quality, heavy-duty bumpers and accessories for most of today's top truck brands. Our all-makes bumpers are made to precise OEM factory standards. They'll fit your vehicle, at a price that suits your budget and supports your success.

We maintain a comprehensive selection to get you back on the road as fast as possible. To accelerate your search, this catalog divides bumpers into three sections: Top Movers—our best all-makes sellers, Mack, and Volvo.

If you're unable to find the bumper you're looking for, check out our website to view the complete line of our inventory. [www.roadchoice.com](http://www.roadchoice.com)





# PART NUMBERS

We utilize a "smart part number" that gives you control of how we will build your bumper.

Bumpers are standard chrome plated steel.  
If additional materials are available, add the letter "S" or "P" to end of the part number.  
**S = Stainless Steel | P = Black Powder Coated**



BUMLH501115**S**: Stainless Steel  
BUMLH501115**P**: Black Powder Coated

## BUMLH501115

PART TYPE  
BUM = Bumper

TRUCK MAKE  
L = Volvo

TRUCK MODEL  
H = VNL

CUTOUTS  
Fog, Tow pins and Vent Holes

END STYLE  
15 = 14" Setback Axle

## END STYLES AND CODES

Standard sizes are in

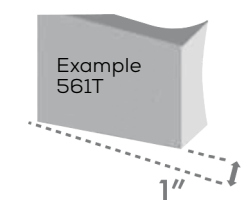
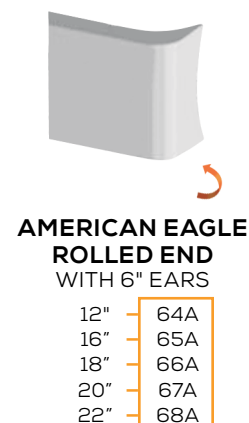
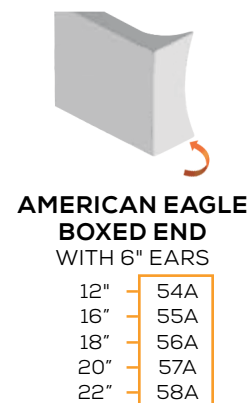
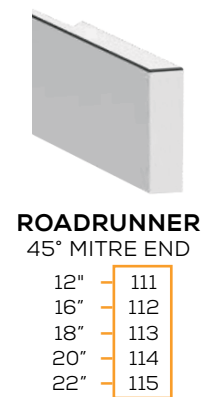
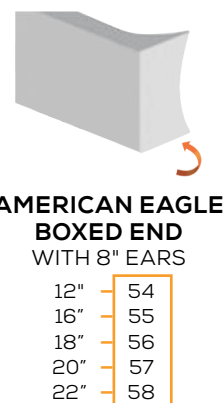
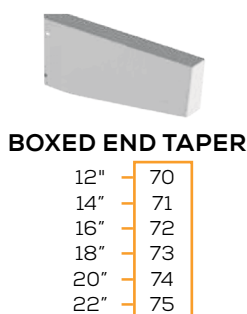
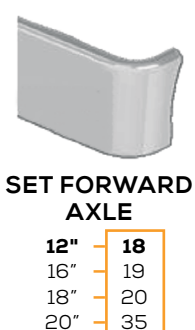
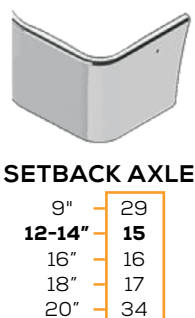
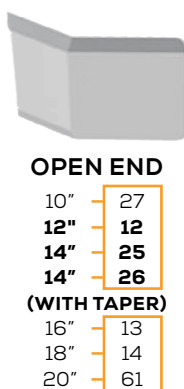
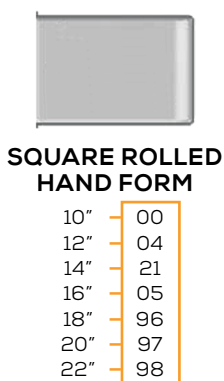
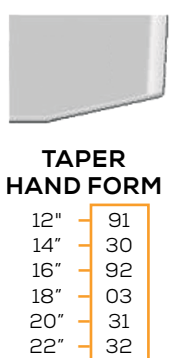
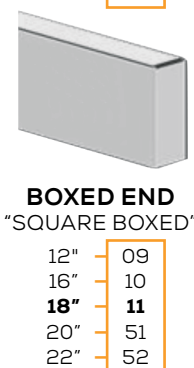
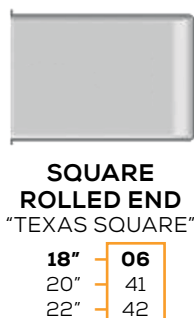
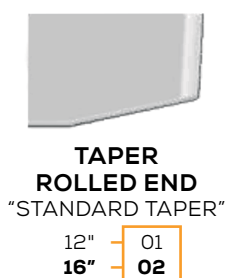



# ROAD CHOICE BUMPERS TOP MOVERS

## HEAVY-DUTY PROTECTION FOR ALL MAKES AND MODELS

Whether you're replacing bumpers on a single truck or a mixed fleet, you're in the right place. Our collection of Top Mover replacement bumpers and accessories covers most of today's heavy-duty truck brands, in a wide range of model years. Each bumper meets the strict quality standards set by the OEM. And each is backed by our proven Road Choice warranty.

To see the full selection of Top Mover bumpers available for OEM makes and models, click here:

**[www.roadchoice.com](http://www.roadchoice.com)**



# TOP MOVERS

Chrome is standard unless otherwise stated.

**S** = Stainless Steel

**P** = Black Powder Coated

## MACK

**GL**

### CH SERIES SET BACK AXLE YEARS 1994-2004

Brackets are included and bolted in.



BUMGL221015 [S/P]  
SBFA Fog/Tow Pins/Step



BUMGL021015 [P]  
SBFA Tow Pins/Step

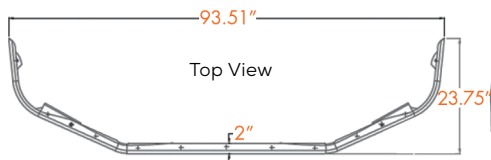

Top View

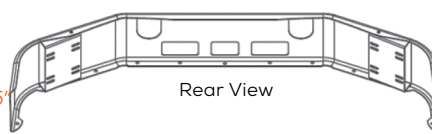

Rear View

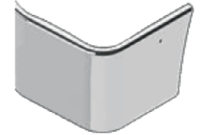

#### SETBACK AXLE

14"	15
16"	16
18"	17
20"	34

**GP**

### MR, MRU, MD SERIES YEARS 2018 & OLDER



BUMGP001112 [S/P]  
Tow Pins/Vent

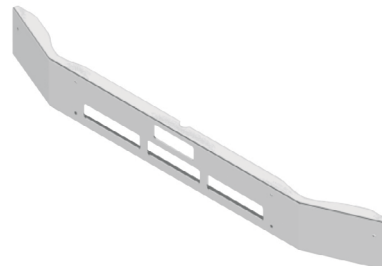

#### OPEN END

10"	27
12"	12
14"	25
16"	13
18"	14

**GV**

### CV SERIES, RD688DM YEARS 2003-2007

Grille guard holes are standard.



BUMGV001012 [S/P]

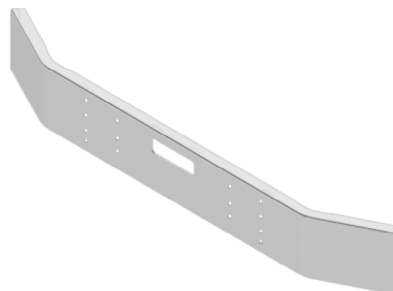

#### OPEN END

12"	12
14"	25
16"	13
18"	14



# TOP MOVERS

Chrome is standard unless otherwise stated.

**S** = Stainless Steel

**P** = Black Powder Coated

## MACK

**GX**

### CHN613 SET FORWARD AXLE YEARS 2005 & NEWER

Also fits Rawhide. Mounts to factory brackets and brackets not included. License plate holes included.



BUMGX021019 [S/P]



BUMGX021019



SET FORWARD  
AXLE

16" — 19

Rear View

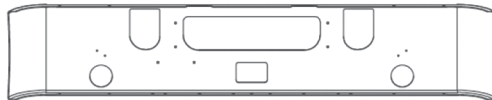

Top View

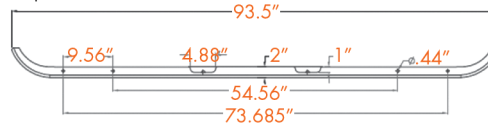

**GY**

### CXU613 SETBACK AXLE YEARS 2008 & NEWER

Brackets not included. Replaces stainless clad bumpers. Brackets required for urethane replacement—see below.



BUMGY121116 [S/P]

Round Fog/Tow Pins/  
Step/Vent



BUMGY021116 [S/P]

Tow Pins/Step/Vent

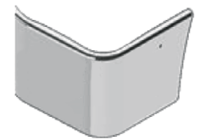

SETBACK AXLE

16" — 16  
18" — 17  
20" — 34

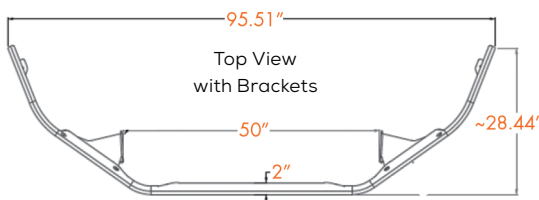

Top View  
with Brackets

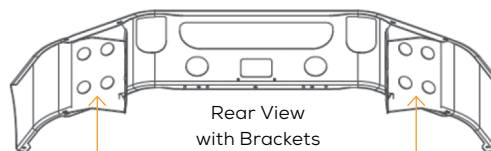

Rear View  
with Brackets

Brackets for CXU plastic replacement:  
BUMGY0116BK



# TOP MOVERS

Chrome is standard unless otherwise stated.

**S** = Stainless Steel

**P** = Black Powder Coated

## VOLVO

**LH**

### VNL SET BACK AXLE YEARS 2004-2017

Mounting brackets are included.



BUMLH501115 [S/P]  
OEM Fog/Tow Pins/Vent



BUMLH001115 [S/P]  
Tow Pins/Vent

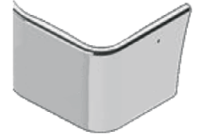

#### SETBACK AXLE

14"	15
16"	16
18"	17
20"	34

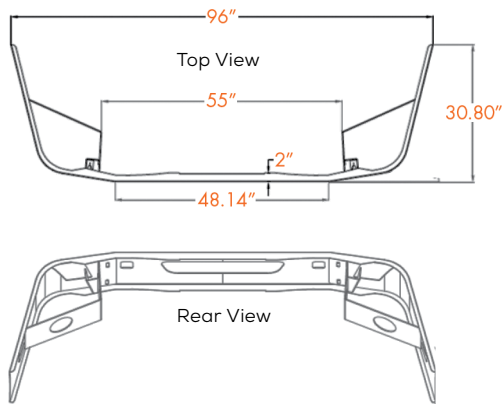

BUMLH501115



## FORD

**BA**

### L-SERIES YEARS 1970-1998

Also models IN7000 and sterling IT9511.

Must be 16" wide or larger for 4 fog light option.



BUMBA001002 [S/P]



#### TAPER ROLLED END "STANDARD TAPER"

12"	01
16"	02
18"	03
20"	31
22"	32



#### SQUARE ROLLED END "TEXAS SQUARE"

10"	00
12"	04
16"	05
18"	06
20"	41
22"	42



BUMBA001002



# TOP MOVERS

Chrome is standard unless otherwise stated.

**S** = Stainless Steel

**P** = Black Powder Coated

## FREIGHTLINER

**CB**

### CABOVER AND CONVENTIONAL AND CLASSIC YEARS 1984-1999



BUMCB2010**02** [P]



#### TAPER ROLLED END "STANDARD TAPER"

12"	01
<b>16"</b>	<b>02</b>
18"	03
20"	31
22"	32

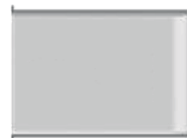

#### SQUARE ROLLED END "TEXAS SQUARE"

12"	04
16"	05
<b>18"</b>	<b>06</b>
20"	41
22"	42



#### BOXED END "SQUARED BOXED"

12"	09
16"	10
<b>18"</b>	<b>11</b>
20"	51
22"	52

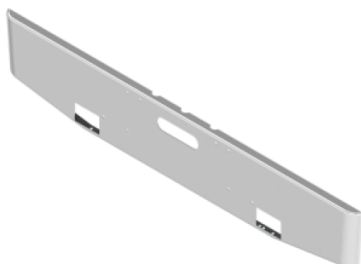

**COG**

### M2 106 BUSINESS CLASS YEARS 2011 & NEWER

Recessed top flange mount, brackets are included.

Also includes upper license plate holes.

Note letters 'COG' in the part number.



BUMCOG0001**15**

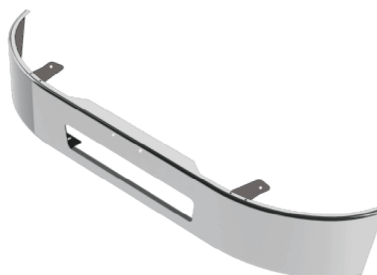
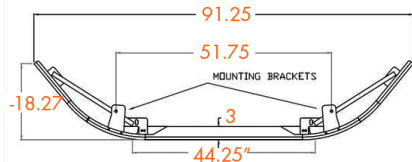

#### SETBACK AXLE

<b>13"</b>	<b>15</b>
16"	16
18"	17
20"	34

# TOP MOVERS

Chrome is standard unless otherwise stated.

**S** = Stainless Steel

**P** = Black Powder Coated

## FREIGHTLINER

**CW**

### COLUMBIA SETBACK AXLE, YEARS 1999-2007

### CENTURY SETBACK AXLE, YEARS 2005-2007

Mounting brackets are included.

Also fits newer model gliders—check chassis configuration.



BUMCW001**15**

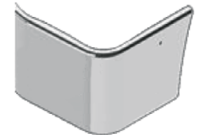
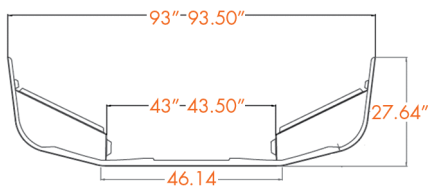

#### SETBACK AXLE

14"	15
16"	16
18"	17
20"	34

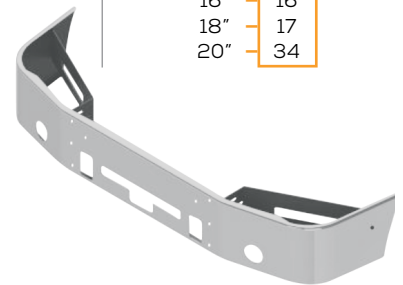

**CY**

### CASCADIA "P3" YEARS 2008-2017

Replaces plastic bumpers only. Standard width radiator trucks only. Mounting brackets and extensions are included.

2 OEM Fogs/Tow Pins/Vent  
No radar



BUMCY501**15X** [S/P]

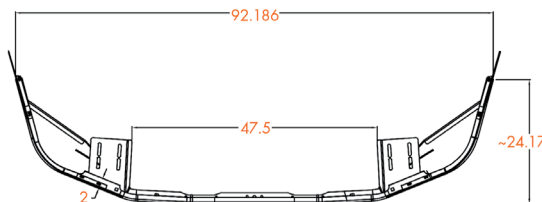

#### SETBACK AXLE WITH TOP EXTENSION

14"	15X
16"	16X
18"	17X
20"	34X

**CZ**

### CORONADO YEARS 2002-2009 & GLIDER CHASSIS

Does not use factory support brackets or ends caps.



BUMCZ1001**707** [P]



BUMCZ0001**707** [P]



#### GULLWING

19"	707
-----	-----





# TOP MOVERS

Chrome is standard unless otherwise stated.

**S** = Stainless Steel

**P** = Black Powder Coated

## INTERNATIONAL

**EM**

**4000 SERIES, 7000 SERIES, 8000 SERIES  
YEARS 1990-2004**

Two-bolt pattern



BUMEM2010**24**



**WRAP AROUND  
"FACTORY STYLE"**

10" - **24**

## KENWORTH

**AVAILABLE  
END STYLES**



**TAPER  
ROLLED END**  
"STANDARD TAPER"

12" - 01  
**16" - 02**  
18" - 03  
20" - 31  
22" - 32



**SQUARE  
ROLLED END**  
"TEXAS SQUARE"

12" - 04  
16" - 05  
**18" - 06**  
20" - 41  
22" - 42

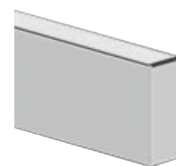

**BOXED END**  
"SQUARED BOXED"

12" - 09  
16" - 10  
**18" - 11**  
20" - 51  
22" - 52



**GULLWING**

16" - **07**

**FE**

**W900B YEARS 1982-2010  
W900L YEARS 1982 & NEWER**



BUMFE2210**06** [P]

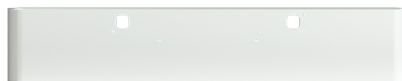

BUMFE0010**41** [S/P]



BUMFE0210**06** [S/P]



BUMFE021002

# TOP MOVERS

Chrome is standard unless otherwise stated.

**S** = Stainless Steel

**P** = Black Powder Coated

## KENWORTH

FS

### T270, T370 SET BACK AXLE YEARS 2008 & NEWER

Adapter brackets included with the 16" width only.

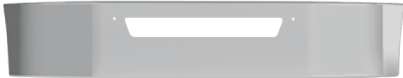

BUMFS001016 [P]

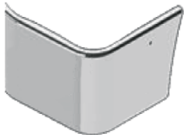

SETBACK AXLE

16" — 16

Adapter bracket  
shown installed  
top view

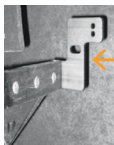

FV

### T680 SET BACK AXLE YEARS 2013 & NEWER

Mounting brackets are included.



BUMFV0010708 [P]

Tow Pins



SETBACK AXLE WITH  
TOP EXTENSION

14" — 708  
16" — 709  
18" — 711  
20" — 712

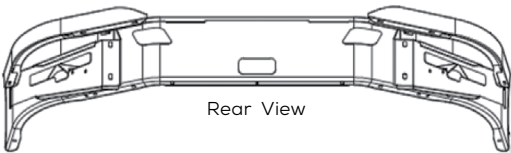
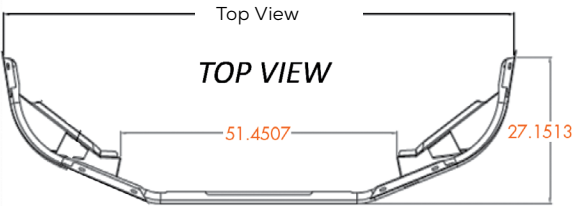



# TOP MOVERS

Chrome is standard unless otherwise stated.

**S** = Stainless Steel

**P** = Black Powder Coated

## PETERBILT

**HC**

**379, 378, 357  
YEARS 1987-2007**



BUMHC2010**02** [S/P]



BUMHC0010**02** [S/P]

**Others Not Shown**

BUMHC0010**01** [S/P]

BUMHC0010**020** [P]

BUMHC0010**06R15**

BUMHC0010**060**



**TAPER  
ROLLED END**  
"STANDARD TAPER"

12"	01
<b>16"</b>	<b>02</b>
18"	03
20"	31
22"	32



**SQUARE  
ROLLED END**  
"TEXAS SQUARE"

12"	04
16"	05
<b>18"</b>	<b>06</b>
20"	41
22"	42

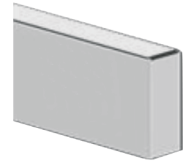

**BOXED END**  
"SQUARED BOXED"

12"	09
16"	10
<b>18"</b>	<b>11</b>
20"	51
22"	52



BUMHC0010**06** [S]

Tow Pins

**HS**

**387 SET BACK AXLE YEARS 2002-2011**

Mounting brackets are included.



BUMHS2210**16** [P]

Fogs/Tow Pins/Step

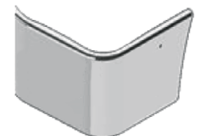

**SETBACK AXLE**

16"	16
18"	17
20"	34

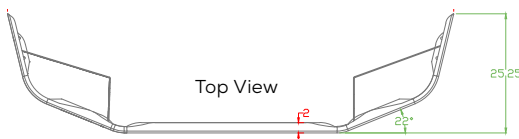

Top View

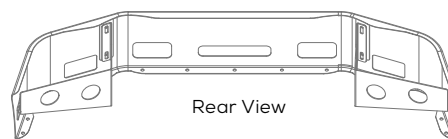

Rear View

# TOP MOVERS

Chrome is standard unless otherwise stated.

**S** = Stainless Steel

**P** = Black Powder Coated

## PETERBILT

**HU**

### 386 SET BACK AXLE YEARS 2006-2015

Mounting brackets are included. Replaces plastic bumpers only.



BUMHU0210**16**

Tow Pins/Step

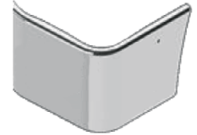
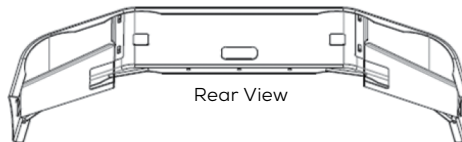
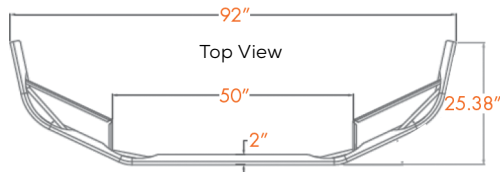

#### SETBACK AXLE

16"	16
18"	17
20"	34

**HV**

### 365, 367, 388, 389, 567 YEARS 2007 & NEWER Also fits KW W990



BUMHV2010**02** [P]

Fogs/Tow Pins



BUMHV0010**02** [S/P]

Tow Pins

#### Others Not Shown

BUMHV0010**11** [S/P] Tow Pins

BUMHV0010**51** [P]



#### TAPER ROLLED END "STANDARD TAPER"

12"	01
<b>16"</b>	<b>02</b>
18"	03
20"	31
22"	32



#### SQUARE ROLLED END "TEXAS SQUARE"

12"	04
16"	05
<b>18"</b>	<b>06</b>
20"	41
22"	42

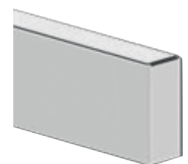

#### BOXED END "SQUARED BOXED"

12"	09
16"	10
<b>18"</b>	<b>11</b>
20"	51
22"	52



BUMHV0010**06** [S/P]

Tow Pins



# TOP MOVERS

Chrome is standard unless otherwise stated.

**S** = Stainless Steel

**P** = Black Powder Coated

## PETERBILT

**HX**

### 367, 567 SET BACK AXLE YEARS 2007 & NEWER

Mounts to factory brackets.

Two sets of license plate holes come standard.

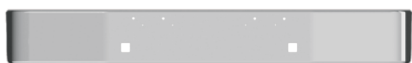

BUMHX001015 [S/P]

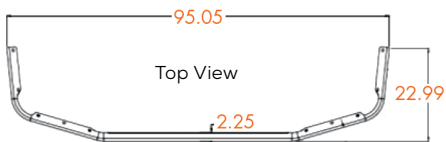

Top View

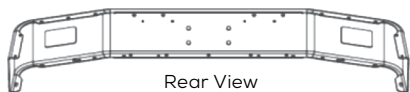

Rear View

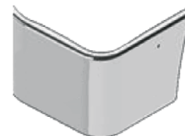
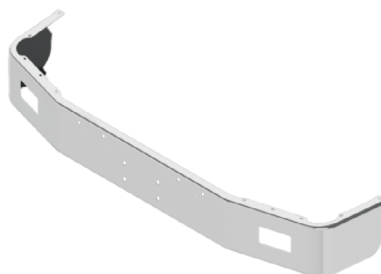

#### SETBACK AXLE

12"	15
16"	16
18"	17
20"	34

**HZ**

### 579 SET BACK AXLE YEARS 2012-2021

Mounting brackets are included.



BUMHZ011016Y [S/P]

Tow Pins/Step

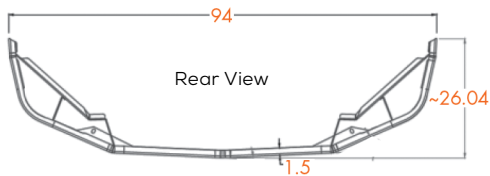

Rear View

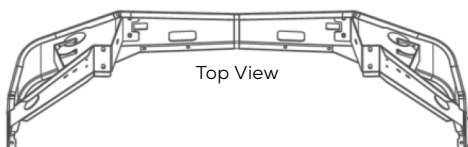

Top View

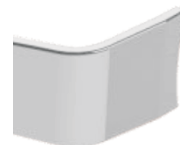

#### HZ SETBACK AXLE

16.5"	16Y
18"	17Y

## WESTERN STAR

IH



4900SF  
YEARS 2008 & NEWER

44"



BUMIH0010**06** [P]



		
<b>TAPER ROLLED END</b> "STANDARD TAPER"	<b>SQUARE ROLLED END</b> "TEXAS SQUARE"	<b>BOXED END</b> "SQUARED BOXED"
12" — 01	12" — 04	12" — 09
<b>16" — 02</b>	16" — 05	16" — 10
18" — 03	<b>18" — 06</b>	<b>18" — 11</b>
20" — 31	20" — 41	20" — 51
22" — 32	22" — 42	22" — 52

# ROAD CHOICE BUMPERS MACK

## HEAVY-DUTY PROTECTION FOR MACK TRUCKS

Our selection of Mack replacement bumpers and accessories is extensive—and easy to shop when you search by model and year. Each part is built to strict OEM standards and ready to live up to the Mack reputation for rugged quality.



# MACK BUMPERS

Chrome is standard unless otherwise stated.

**S** = Stainless Steel

**P** = Black Powder Coated

## R600, R700

### AVAILABLE END STYLES



12"	01
14"	30
<b>16"</b>	<b>02</b>
18"	03
20"	31
22"	32



12"	04
16"	05
<b>18"</b>	<b>06</b>
20"	41
22"	42

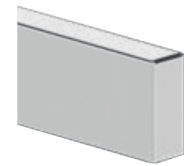

12"	09
16"	10
<b>18"</b>	<b>11</b>
20"	51
22"	52

**GC**

Add "0" directly after the end style for 10-gauge steel, chrome plated.

Add "GG" to the end of the whole part number for the grille guard holes.

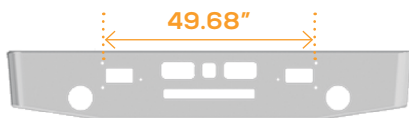

BUMGC1011**02** [S/P]

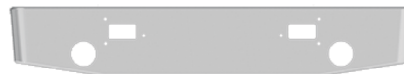

BUMGC1010**02** [S/P]



BUMGC1001**02** [S/P]



BUMGC0011**02** [S/P]



BUMGC1000**02** [S/P]



BUMGC0010**02** [S/P]



BUMGC0001**02** [S/P]



BUMGC0000**02** [S/P] GG

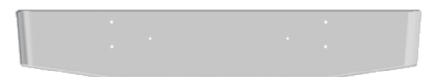

BUMGC0000**02** [S/P]

# MACK BUMPERS

Chrome is standard unless otherwise stated.

**S** = Stainless Steel

**P** = Black Powder Coated

## WESTERN CONTRACTOR, RD688, RD690 YEARS 1989-2001

### AVAILABLE END STYLES



14"	30
<b>16"</b>	<b>02</b>
18"	03
20"	31
22"	32



16"	05
<b>18"</b>	<b>06</b>
20"	41
22"	42

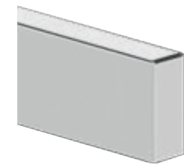

16"	10
<b>18"</b>	<b>11</b>
20"	51
22"	52

**GH**

Add "0" directly after the end style for 10-gauge steel, chrome plated.

Add "GG" to the end of the whole part number for the grille guard holes.



BUMGH1011**02** [S/P]

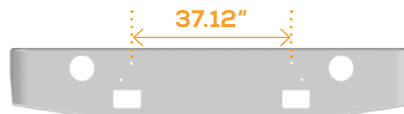

BUMGH1010**02** [S/P]



BUMGH1001**02** [S/P]



BUMGH0011**02** [S/P]

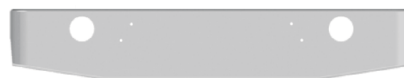

BUMGH1000**02** [S/P]

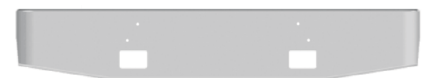

BUMGH0010**02** [S/P]



BUMGH0001**02** [S/P]

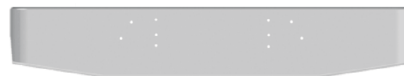

BUMGH0000**02** [S/P] GG

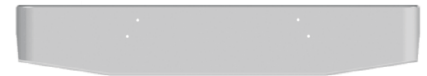

BUMGH0000**02** [S/P]

# MACK BUMPERS

Chrome is standard unless otherwise stated.

**S** = Stainless Steel

**P** = Black Powder Coated

## CH SERIES SET FORWARD AXLE YEARS 1994-2004



Mounting brackets are included and bolted in.



BUMGJ221018 [S/P]



BUMGJ021018 [S/P]



BUMGJ220018 [S/P]



BUMGJ020018 [S/P]



BUMGJ201018 [S/P]

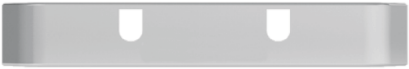

BUMGJ001018 [S/P]



BUMGJ200018 [S/P]

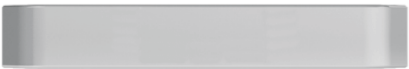

BUMGJ000018 [S/P]

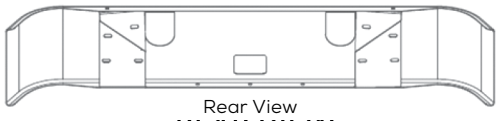

Rear View

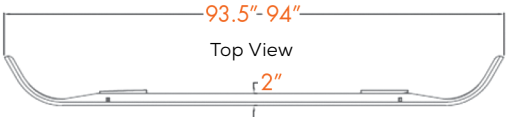

93.5"-94"

Top View

r2"



SET FORWARD  
AXLE

12"	18
16"	19
18"	20
20"	35



BUMGJ221018



# MACK BUMPERS

Chrome is standard unless otherwise stated.

**S** = Stainless Steel

**P** = Black Powder Coated

## CH SERIES SETBACK AXLE YEARS 1994-2004

**GL**

Mounting brackets are included and bolted in.



BUMGL2210**15** [S/P]



BUMGL0210**15** [S/P]



BUMGL2200**15** [S/P]



BUMGL0200**15** [S/P]



BUMGL2010**15** [S/P]



BUMGL0010**15** [S/P]



BUMGL2000**15** [S/P]



BUMGL0000**15** [S/P]

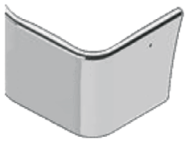

SETBACK AXLE

14"	15
16"	16
18"	17
20"	34

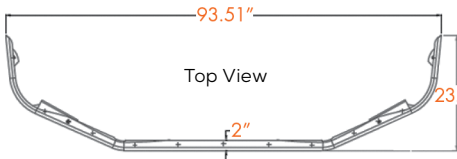
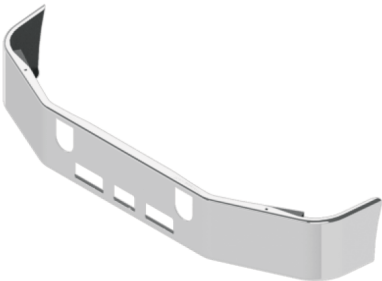

Top View

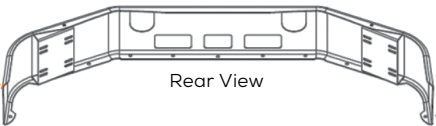

Rear View

# MACK BUMPERS

Chrome is standard unless otherwise stated.

**S** = Stainless Steel

**P** = Black Powder Coated

## CH SERIES SETBACK AXLE YEARS PRE 1994



Mounting brackets are included and bolted in.



BUMGM2210**15** [S/P]  
**16** [S/P NO CHROME]



BUMGM0210**15** [S/P]



BUMGM2200**15** [S/P]



BUMGM0200**15** [S/P]



BUMGM2010**15** [S/P]



BUMGM0010**15** [S/P]



BUMGM2000**15** [S/P]



BUMGM0000**15** [S/P]

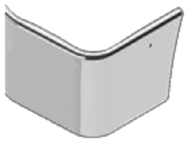

SETBACK AXLE

14"	15
16"	16
18"	17
20"	34

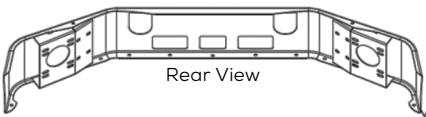
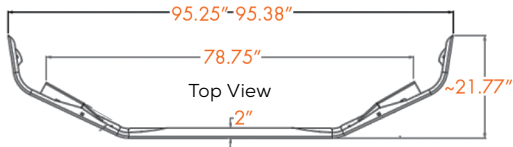
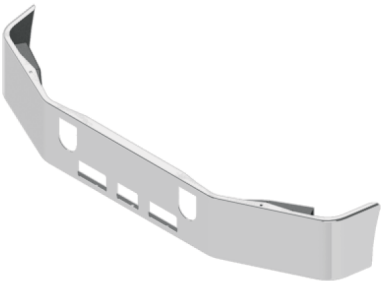

# MACK BUMPERS

Chrome is standard unless otherwise stated.

**S** = Stainless Steel

**P** = Black Powder Coated

## CL SERIES 10.5" BREAK-BACK YEARS 1994-2003

**GN**

Mounting brackets are included and bolted in.



BUMGN2020<sup>25</sup> [S/P]

OUTBOARD TOW PINS

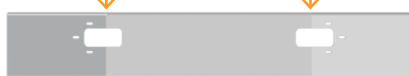

BUMGN0020<sup>25</sup> [S/P]

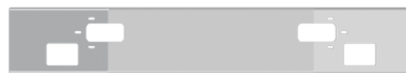

BUMGN2010<sup>25</sup> [S/P]

CENTER TOW PIN



BUMGN0010<sup>25</sup> [S/P]

Others Not Shown

BUMGN0000<sup>25</sup> [S/P]

BUMGN2000<sup>25</sup> [S/P]



OPEN END

12"	12
14"	25
16"	13
18"	14

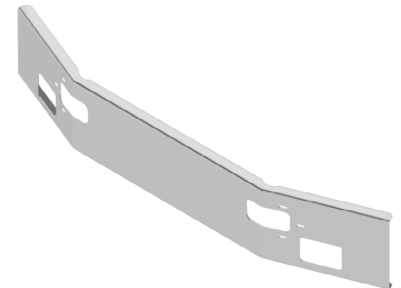

## MR, MD SERIES 7" BREAK-BACK YEARS 2018 & OLDER

**GP**



BUMGP0011<sup>27</sup> [S/P]



BUMGP0001<sup>27</sup> [S/P]



BUMGP0010<sup>27</sup> [S/P]

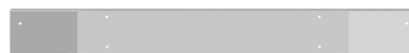

BUMGP0000<sup>27</sup> [S/P]



OPEN END

10"	27
12"	12
14"	25
16"	13
18"	14

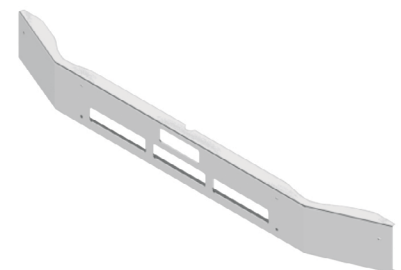



# MACK BUMPERS

Chrome is standard unless otherwise stated.

**S** = Stainless Steel

**P** = Black Powder Coated

## RD688, RD690, 6" BREAK-BACK YEARS 1994-2003

**GQ**

Grille guards are standard.

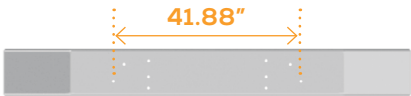

BUMGQ0000**25** [S/P]

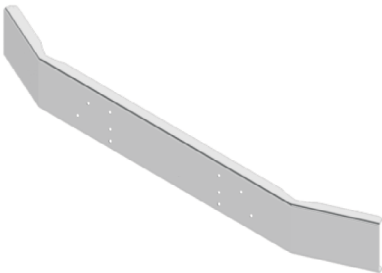

**OPEN END**

10"	27
<b>12"</b>	<b>12</b>
<b>14"</b>	<b>25</b>
16"	13
18"	14

## RD SERIES SBA 6" BREAK-BACK YEARS 1979-1988

**GS**

Grille guards are standard.

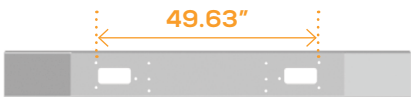

BUMGS0010**12** [S/P]

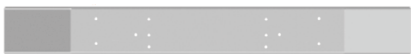

BUMGS0000**12** [S/P]

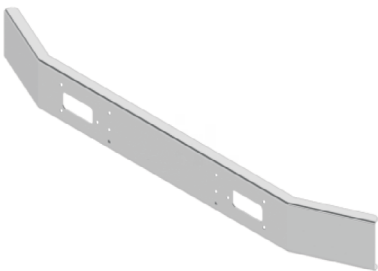

**OPEN END**

10"	27
<b>12"</b>	<b>12</b>
<b>14"</b>	<b>25</b>
16"	13
18"	14

# MACK BUMPERS

Chrome is standard unless otherwise stated.

**S** = Stainless Steel

**P** = Black Powder Coated

## GRANITE, CV513, CV533 SFA YEARS 2003 & NEWER

### AVAILABLE END STYLES



12"	01
14"	30
<b>16"</b>	<b>02</b>
18"	03
20"	31
22"	32

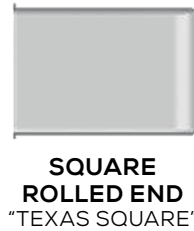

12"	04
16"	05
<b>18"</b>	<b>06</b>
20"	41
22"	42

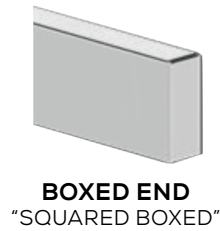

12"	09
16"	10
<b>18"</b>	<b>11</b>
20"	51
22"	52

**GT**

Add "0" directly after the end style for 10-gauge steel, chrome plated.  
Add "GG" to the end of the whole part number for the grille guard holes.



BUMGT2210**02** [S/P]



BUMGT2000**02** [S/P]



BUMGT0200**02** [S/P]



BUMGT2200**02** [S/P]



BUMGT0210**02** [S/P]

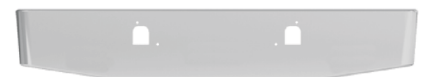

BUMGT0010**02** [S/P]



BUMGT2010**02** [S/P]

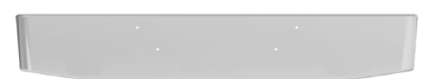

BUMGT0000**02** [S/P]

# MACK BUMPERS

Chrome is standard unless otherwise stated.

**S** = Stainless Steel

**P** = Black Powder Coated

## CX SERIES, VISION SBA YEARS 2001-2004

**GU**

Mounting brackets are included.



BUMGU221016 [S/P]



BUMGU021016



BUMGU220016 [S/P]



BUMGU020016 [S/P]



BUMGU201016 [S/P]

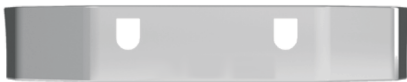

BUMGU001016



BUMGU200016 [S/P]

Others Not Shown

BUMGU000016 [S/P]

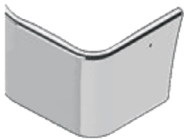

SETBACK AXLE

16"	16
18"	17
20"	34

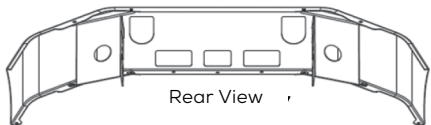
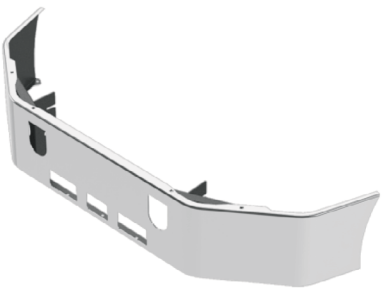

Rear View

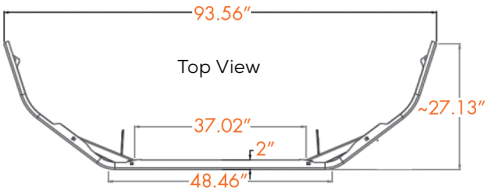

Top View



# MACK BUMPERS

Chrome is standard unless otherwise stated.

**S** = Stainless Steel

**P** = Black Powder Coated

## CV SERIES RD688DM YEARS 2003-2007

**GV**

Grille guard holes are standard.

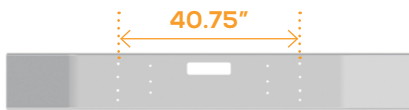

BUMGV0010**12** [S/P]  
**25** [S NO CHROME]

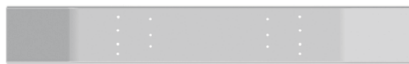

BUMGV0000**12** [S/P]  
**25** [S NO CHROME]

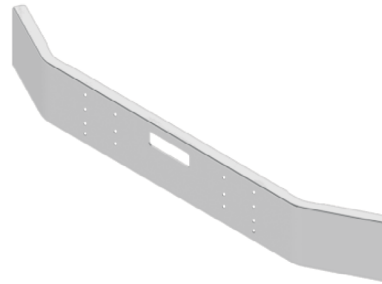

**OPEN END**

12"	12
14"	25
16"	13
18"	14

## CXN SERIES YEARS 2005 & NEWER | CXP YEARS 2007 & NEWER

**GW**

Mounting brackets are included.  
One set of upper license plate holes are included.



BUMGW1210**16** [S/P]



BUMGW1000**16** [S/P]



BUMGW1200**16** [S/P]



BUMGW0210**16** [S/P]



BUMGW1010**16** [S/P]



BUMGW0010**16** [S/P]

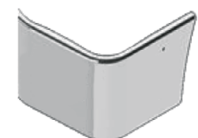

**SETBACK AXLE**

16"	16
18"	17
20"	34

**Others Not Shown**

BUMGW0000**16** [S/P]

BUMGW1211**16**

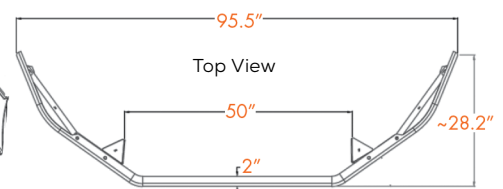
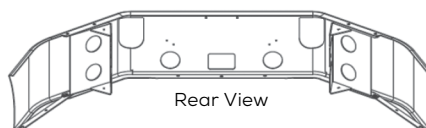

# MACK BUMPERS

Chrome is standard unless otherwise stated.

**S** = Stainless Steel

**P** = Black Powder Coated

## CHN613 YEARS 2005 & NEWER

**GX**

Also fits Rawhide. Mounts to factory brackets that are not included.  
License plate holes are included.



BUMGX121119



BUMGX020019 [S/P]



BUMGX121019 [S/P]

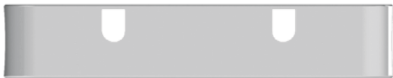

BUMGX001019 [S/P]



BUMGX100019 [S/P]

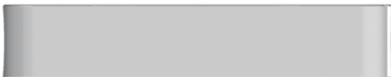

BUMGX000019 [S/P]



BUMGX021019 [S/P]



SET FORWARD  
AXLE

16" - 19"

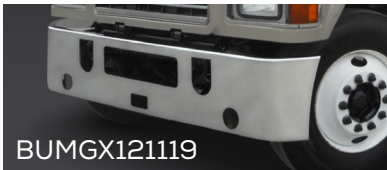

BUMGX121119

Rear View



Top View

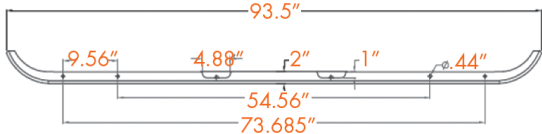

# MACK BUMPERS

Chrome is standard unless otherwise stated.

**S** = Stainless Steel

**P** = Black Powder Coated

## CXU613 YEARS 2008-2010 & ANTHEM 2017-NEWER

**GY**

Brackets are not included. Brackets required for CXU plastic replacement.  
Replaces stainless clad bumpers on CXU & Anthem.  
No Anthem plastic replacement available.



BUMGY1211**16** [S/P]  
**17 / 34** [S/P ONLY, NO CHROME]  
ROUND FOGS./TOW PINS/



BUMGY0210**16** [S/P]  
TOW PINS/STEP



BUMGY1200**16**  
[S/P ONLY, NO CHROME]  
ROUND FOGS/STEP



BUMGY0200**16**  
[S/P ONLY, NO CHROME]  
STEP



BUMGY0211**16** [S/P]  
**34** [S/P ONLY, NO CHROME]  
TOW PINS/STEP/VENT



BUMGY0010**16**  
[S/P ONLY, NO CHROME]  
TOW PINS



**SETBACK AXLE**

16"	16
18"	17
20"	34



### Others Not Shown

BUMGY0000**16**  
[S/P ONLY, NO CHROME]

BUMGY1000**16** [S/P]  
**17 / 34** [S/P ONLY, NO CHROME]

BUMGY1010**16**  
[S/P ONLY, NO CHROME]

BUMGY1211**16**NCH  
[NO CHROME ON 16]

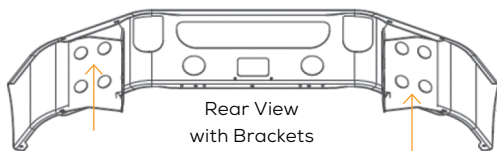
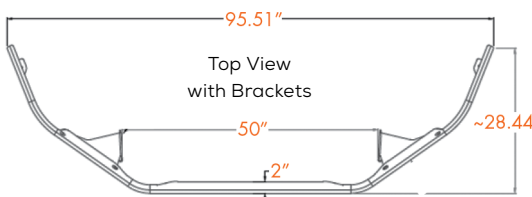

Brackets for CXU plastic replacement:  
BUMGY0116BK

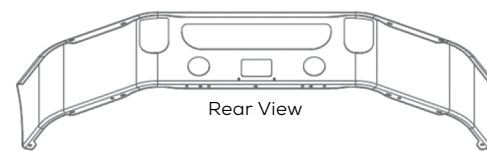
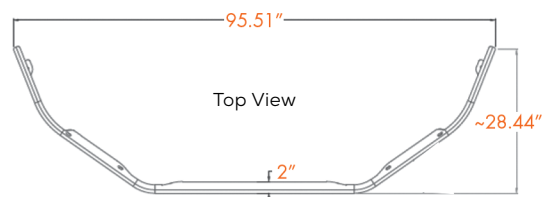



# ROAD CHOICE BUMPERS VOLVO

## HEAVY-DUTY PROTECTION FOR VOLVO TRUCKS

Road Choice Volvo replacement bumpers and accessories are built to Volvo's highest standards for quality and safety. Whether you're repairing a VNL, VNM, VNR, VT, White, WA or WG, we've got you covered with the parts you need at prices that help protect your budget.

# VOLVO BUMPERS

Chrome is standard unless otherwise stated.

**S** = Stainless Steel

**P** = Black Powder Coated

## WX XPEDITOR YEARS 2003-2010

**KB**

Note outside shape and bolt pattern prior to ordering.



BUMKB0010**22**



**WRAP AROUND**  
"FACTORY STYLE"

12" — **22**

## WA, WIA SBA YEARS 1988-1997

**LA**

Mounting brackets are included.

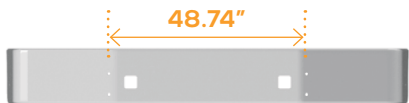

BUMLA0010**15** [S/P]

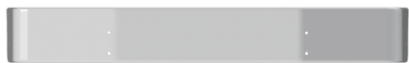

BUMLA0000**15** [S/P]

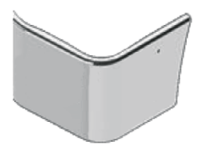

**SETBACK AXLE**

**13"** — **15**  
16" — 16  
18" — 17  
20" — 34

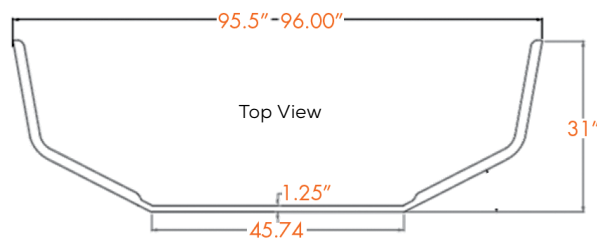

Top View

# VOLVO BUMPERS

Chrome is standard unless otherwise stated.

**S** = Stainless Steel

**P** = Black Powder Coated

## VNL SERIES YEARS 2003 & OLDER

**LB**

Replaces plastic/fiberglass bumpers only. Mounting brackets are included. Must be 16" (16) for fog light options.



BUMLB401016 [S/P]



BUMLB001016 [S/P]



BUMLB201016 [S/P]



BUMLB000016 [S/P]

Others Not Shown

BUMLB200016 [S/P]

BUMLB400016 [S/P]



BUMLB001016

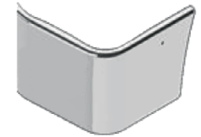
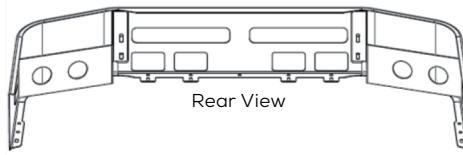
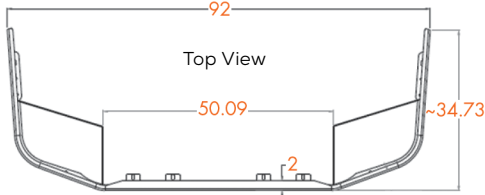

SETBACK AXLE

13"	15
16"	16
18"	17
20"	34

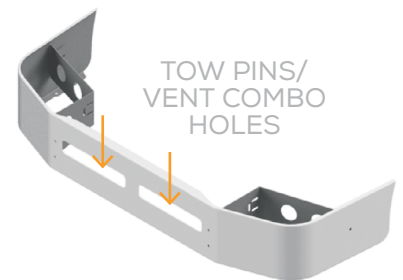

TOW PINS/  
VENT COMBO  
HOLES

## WG SBA YEARS 1991-2001

**LC**

Mounting brackets are included.

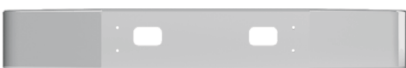

BUMLC001015 [S/P]



BUMLC000015 [S/P]

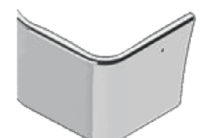
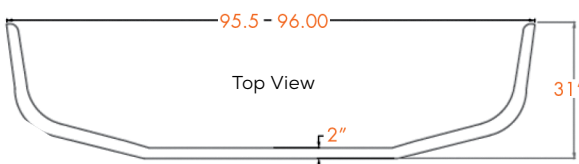

SETBACK AXLE

13"	15
16"	16
18"	17
20"	34

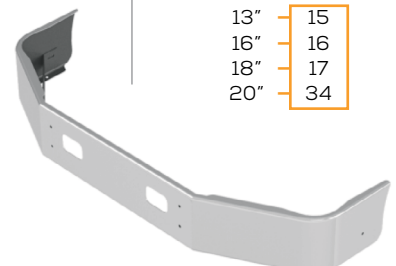

# VOLVO BUMPERS

Chrome is standard unless otherwise stated.

**S** = Stainless Steel

**P** = Black Powder Coated

## VNM42T-VNM64T YEARS 1998-2003

**LD**

Mounting brackets are included.



BUMLD001115 [S/P]

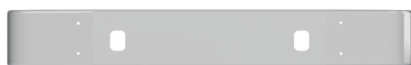

BUMLD001015 [S/P]



BUMLD000115 [S/P]

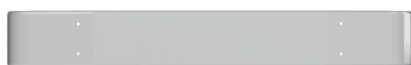

BUMLD000015 [S/P]

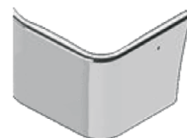
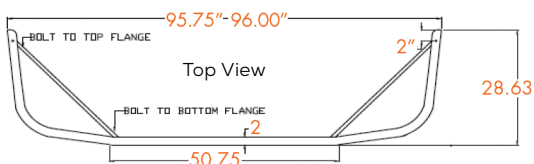

SETBACK AXLE

12"	15
16"	16
18"	17
20"	34



## VNL42T, VNL64T YEARS 1996-2003

**LE**

Replaces stainless clad bumpers only.  
Mounting brackets are included.



BUMLE201115 [S/P]



BUMLE001115 [S/P]

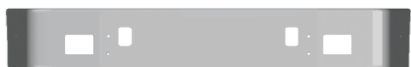

BUMLE201015 [S/P]



BUMLE001015 [S/P]

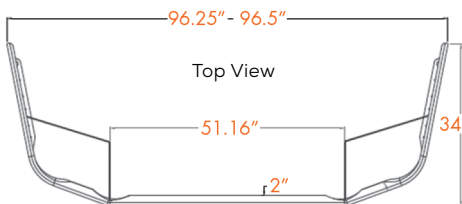

SEE SETBACK  
AXLE ABOVE FOR  
AVAILABLE SIZES

Others Not Shown

BUMLE000015

BUMLE000115 [S/P]

BUMLE200015 [P]

BUMLE200115 [S/P]

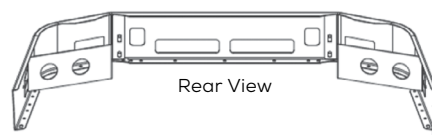



# VOLVO BUMPERS

Chrome is standard unless otherwise stated.

**S** = Stainless Steel

**P** = Black Powder Coated

## WHITE SBA YEARS 1987-2001

**LF**

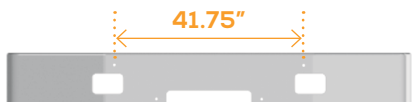

BUMLF0011**02** [S/P]

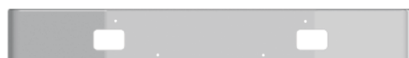

BUMLF0010**02** [S/P]



BUMLF0001**02** [S/P]



BUMLF0000**02** [S/P]

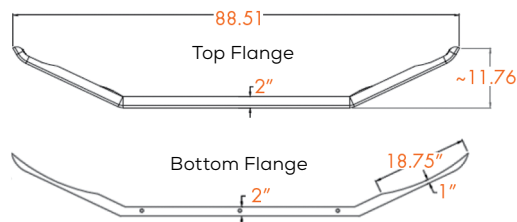

**TAPER  
ROLLED END**  
"STANDARD TAPER"

16"	<b>02</b>
18"	03
20"	31
22"	32

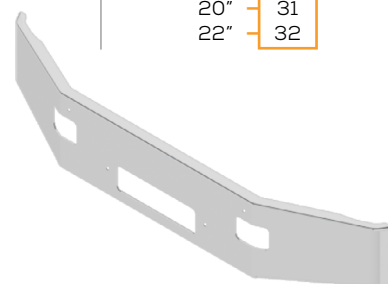

## VNM SERIES YEARS 2004 & NEWER

**LG**

Mounting brackets are included.



BUMLG0011**15** [S/P]



BUMLG001115

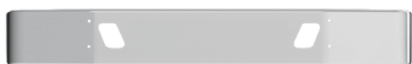

BUMLG0010**15** [S/P]



BUMLG0000**15** [S/P]

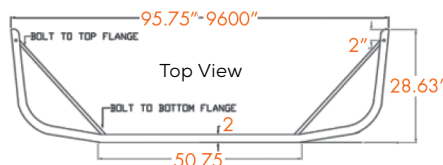

**SETBACK AXLE**

13"	<b>15</b>
16"	16
18"	17
20"	34

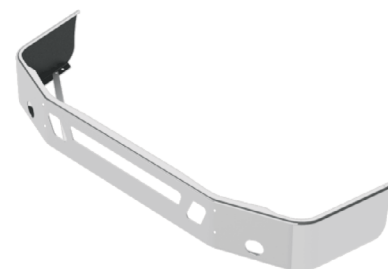

**Others Not Shown**

BUMLG2011**15**

BUMLG0001**15** [S/P]

# VOLVO BUMPERS

Chrome is standard unless otherwise stated.

**S** = Stainless Steel

**P** = Black Powder Coated

## VNL SERIES YEARS 2004-2017

**LH**

Mounting brackets are included.



BUMLH5011**15** [S/P]  
OEM Fog/Tow Pins/Vent



BUMLH2011**15** [S/P]  
Rectangle Fog/Tow Pins/Vent



BUMLH5010**15** [S/P]  
OEM Fog/Tow Pins



BUMLH2010**15** [S/P]  
Rectangle Fog/Tow Pins



BUMLH0011**15** [S/P]  
Tow Pins/Vent



BUMLH0010**15** [S/P]  
Tow Pins/Vent



BUMLH0000**15** [S/P]  
Mounting Bolts Only

### Others Not Shown

BUMLH0001**15** [S/P]

BUMLH2000**15** [S/P]

BUMLH2001**15** [S/P]

BUMLH5001**15**

**16** [S] **17** [S ONLY]

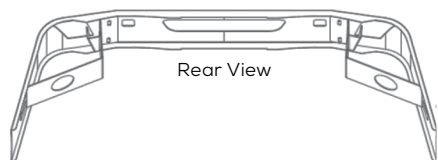
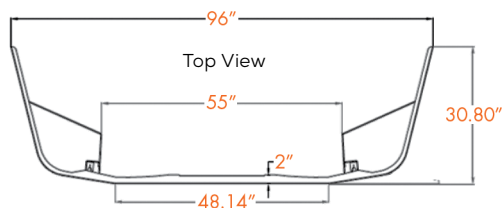

### SETBACK AXLE

14"	15
16"	16
18"	17
20"	34



# VOLVO BUMPERS

Chrome is standard unless otherwise stated.

**S** = Stainless Steel

**P** = Black Powder Coated

## VT SERIES 2006-2008

**LI**

Only available in 18" and 20" widths.  
One set upper license plate holes come standard.



BUMLI501017 [S/P]



BUMLI001017 [S/P]

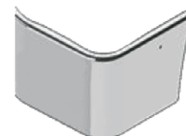
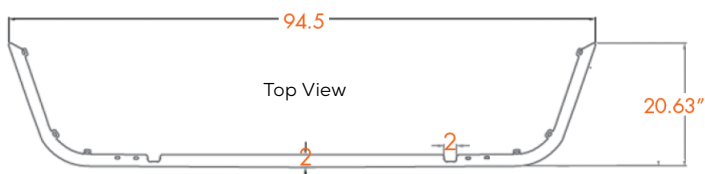

SETBACK AXLE

18"	17
20"	34



## VNR SERIES 2018 & NEWER

**LJ**

Mounting brackets are included.



BUMLJ501115 [S/P]



BUMLJ001115 [S/P]



BUMLJ501015 [S/P]



BUMLJ001015 [S/P]



BUMLJ500115 [S/P]



BUMLJ000015 [S/P]

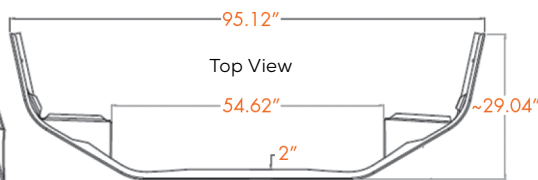
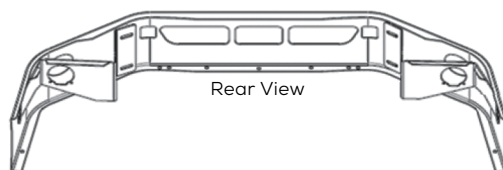

SETBACK AXLE

14"	15
16"	16
18"	17
20"	34



# VOLVO BUMPERS

Chrome is standard unless otherwise stated.

**S** = Stainless Steel  
**P** = Black Powder Coated

## VNL SERIES 2018 & NEWER



Mounting brackets are included.



BUMLL501115 [S/P]



BUMLL001115 [S/P]

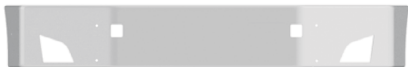

BUMLL501015 [S/P]

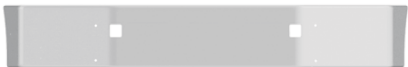

BUMLL001015 [S/P]



BUMLL500115 [S/P]



BUMLL000015 [S/P]

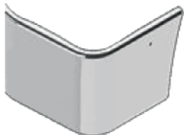

SETBACK AXLE

14"	15
16"	16
18"	17
20"	34



BUMLL501115

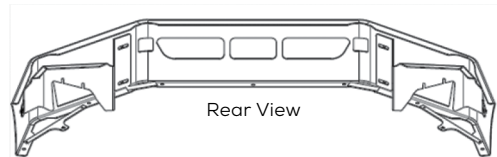

Rear View

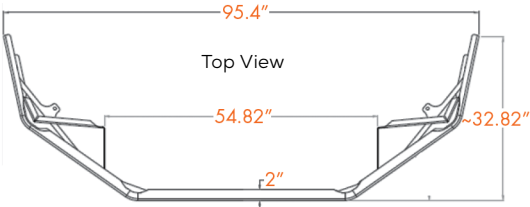

Top View





**ROAD CHOICE®**

© 2022 Road Choice® – All Rights Reserved.  
RCOBUM-22CAT-060922